

2.1 Vision and strategic summary

2.12 Vision statement

Create a unified field where Smithfield's multiple histories and contemporary cultures intermingle.

Smithfield will be a place for all Londoners.

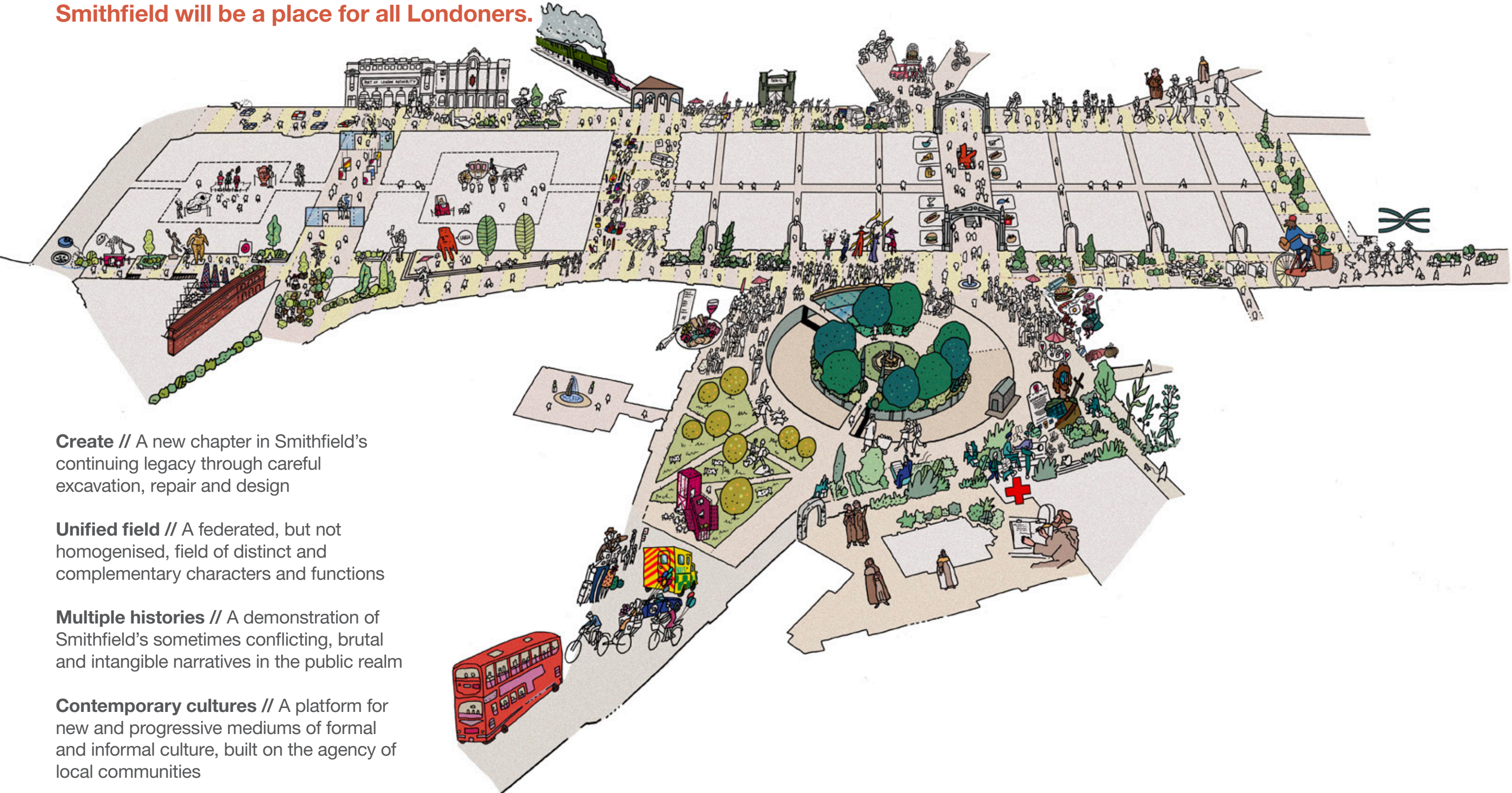

Create // A new chapter in Smithfield's continuing legacy through careful excavation, repair and design

Unified field // A federated, but not homogenised, field of distinct and complementary characters and functions

Multiple histories // A demonstration of Smithfield's sometimes conflicting, brutal and intangible narratives in the public realm

Contemporary cultures // A platform for new and progressive mediums of formal and informal culture, built on the agency of local communities

2.1 Vision and strategic summary

2.13 Project Objectives

Express Smithfield as a unified but diverse cultural district, reflecting its social and spatial legacy as the ‘Field’



Maximise car-free areas, making Smithfield permeable, accessible and welcoming for people who are walking or cycling



Maximise opportunities for new trees and soft landscape



4. Celebrate the ever-changing civic and cultural activity afforded by the flexibility of Smithfield’s streets and spaces



5. Enhance the setting of Smithfield’s heritage assets and amplify the area’s multiple narratives



2.1 Vision and strategic summary

2.14 Key strategic moves



2.1

Vision and strategic summary

2.18

Approach to Healthy Streets

Summary of Healthy Streets scores: existing condition



Summary of Healthy Streets scores: proposed concept design



Key spaces

1

West Smithfield

2

Smithfield Street / Snow Hill

3

Snow Hill

4

Cock Lane

5

Hosier Lane

6

Giltspur Street

7

Rotunda

8

Long Lane

9

Lindsey Street

10

Charterhouse Street

11

East Poultry Avenue

Overall Healthy Streets score

90-100

80-90

70-80

60-70

50-60

< 50

*

Number of '0' scores

A Healthy Streets approach guides the transformation of Smithfield to become less traffic-dominated and more inclusive for a wider audience. It will implement a balanced approach to reconfiguring the area’s road network and resultant character to maximise benefits for pedestrians and cyclists of all abilities, spearheading the radical and necessary changes required to reduce through-traffic in the area – transferring large swathes of land into the public domain for civic and cultural activity.

This approach will require Smithfield to shed some of its existing layers and characteristics, currently perceived as uninviting and irrelevant to many audiences. It will need to look back to its legacy as common ground and as a platform for celebration and gathering to inform future function and character.

2.1 Vision and strategic summary

2.19 Approach to climate resilience

Reducing CO₂ emissions and improving air quality
Reduced motor vehicular traffic

Reducing CO₂ emissions and improving air quality
Improved pedestrian and cycle infrastructure

Managing heat risk
Increased green areas

Enhancing biodiversity
New habitats and multi-layered planting

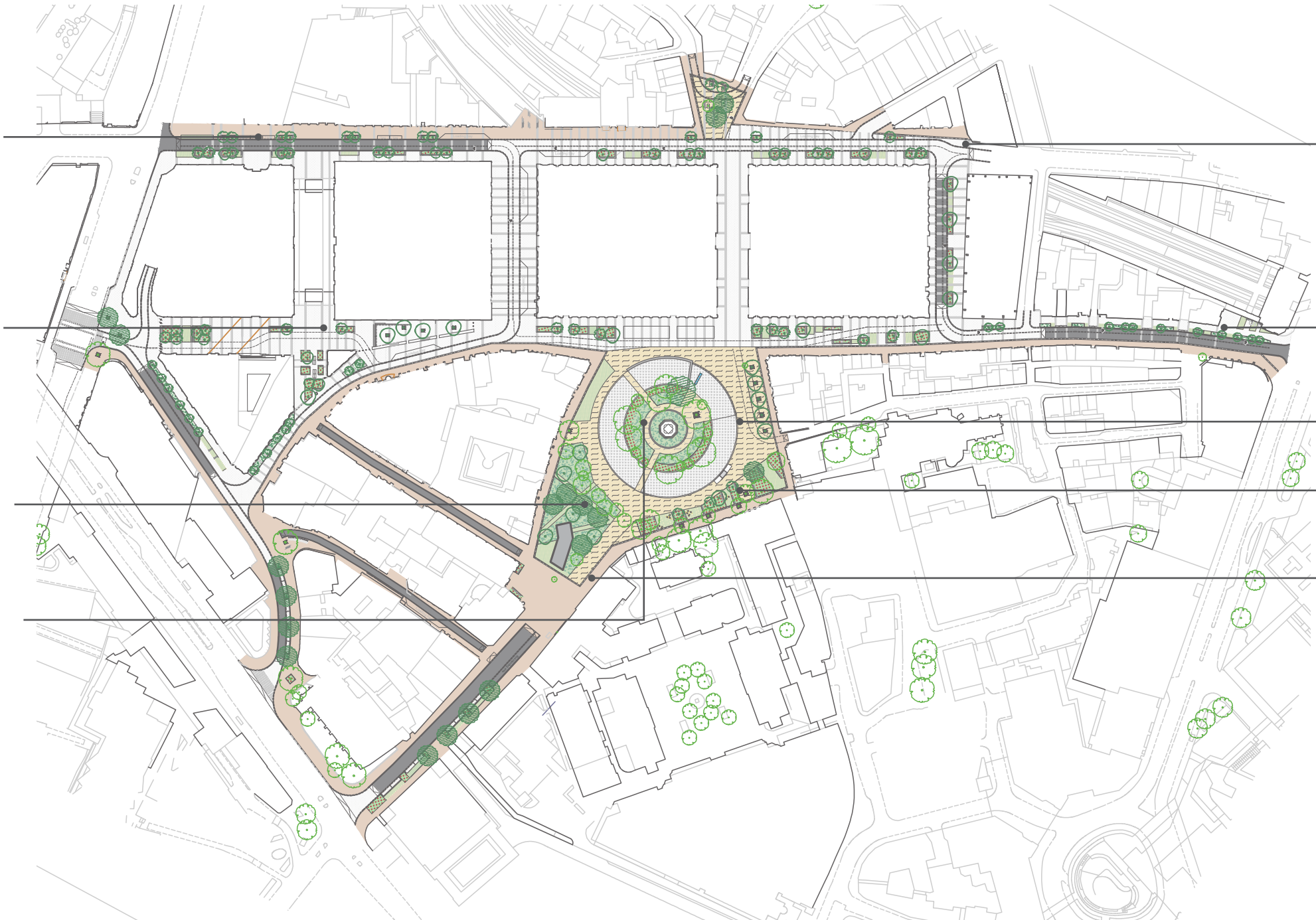

Managing heat risk
Light colour surface material with high albedo

Reducing flood risk
SuDs

Managing heat risk
Permeable hard surfaces

Managing heat risk
Increased tree canopy

Reducing CO₂ emissions and improving air quality
Reused, recycled and reconstituted materials

Smithfield must demonstrate the highest standards in tackling the impacts of climate change, in line with the City of London's Climate Action Strategy. Its transformation from a heavily-trafficked area to a district used by all Londoners will require it to become more resilient through careful and ambitious choices regarding materials, greening and water management. This approach, although varying across the area in response to differing constraints, will aim to unify Smithfield through its transformation to a greener and softer district, where the landscape not only supports, but is integral to its civic and cultural activity.

2.1 Vision and strategic summary

2.111 Approach to lighting and night-time character

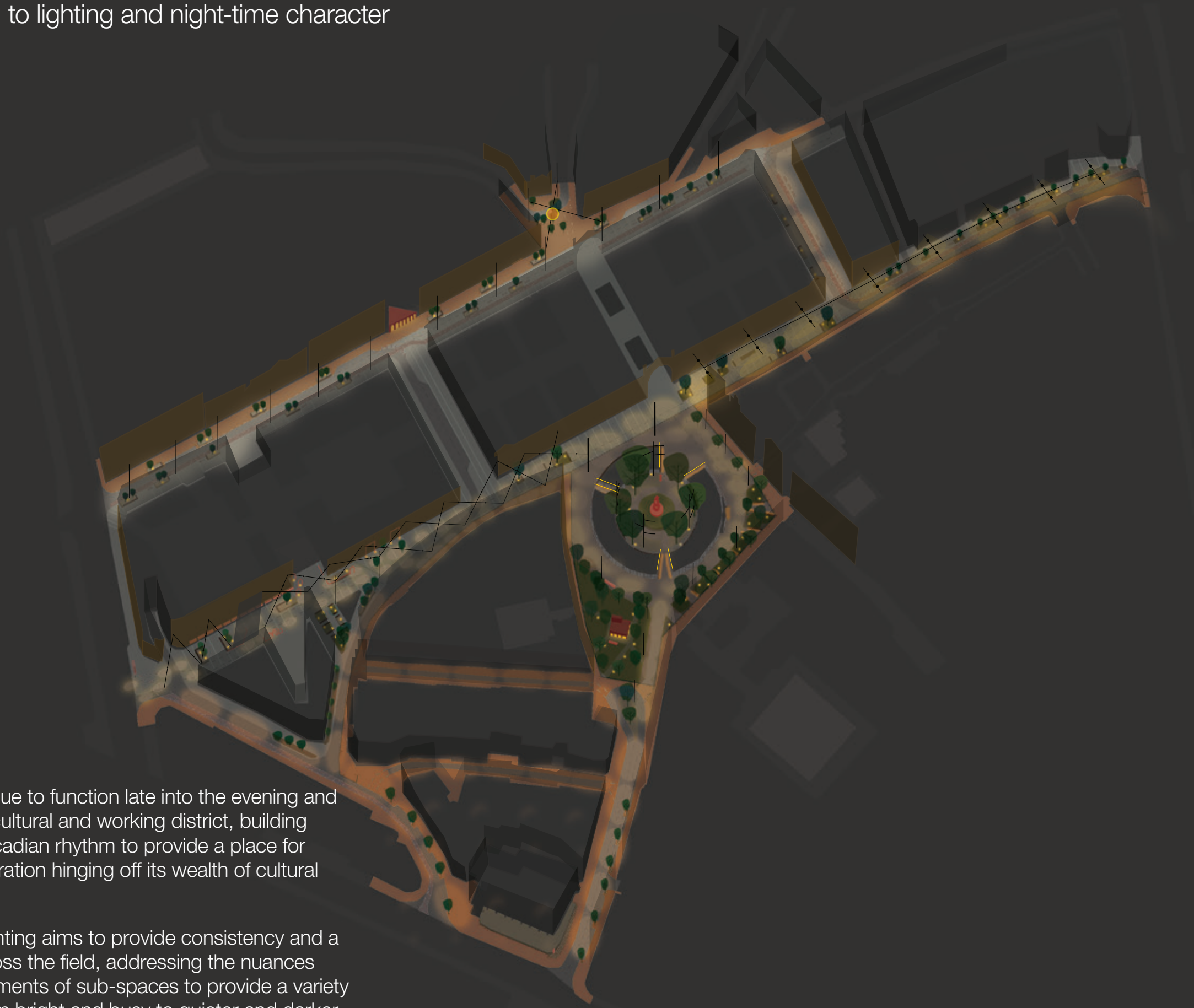

Smithfield will continue to function late into the evening and night as a 24-hour cultural and working district, building upon its existing circadian rhythm to provide a place for gathering and celebration hinging off its wealth of cultural and civic functions.

The approach to lighting aims to provide consistency and a unifying identity across the field, addressing the nuances and specific requirements of sub-spaces to provide a variety of environments from bright and busy to quieter and darker spaces. The lighting strategy will provide a flexible network of infrastructure that enables Smithfield to transform from its everyday functions to accommodate major events, implementing forward-thinking technologies aligned with the City's ambitious Lighting Strategy.